

**Teknik Katalog**  
Technical Catalogue

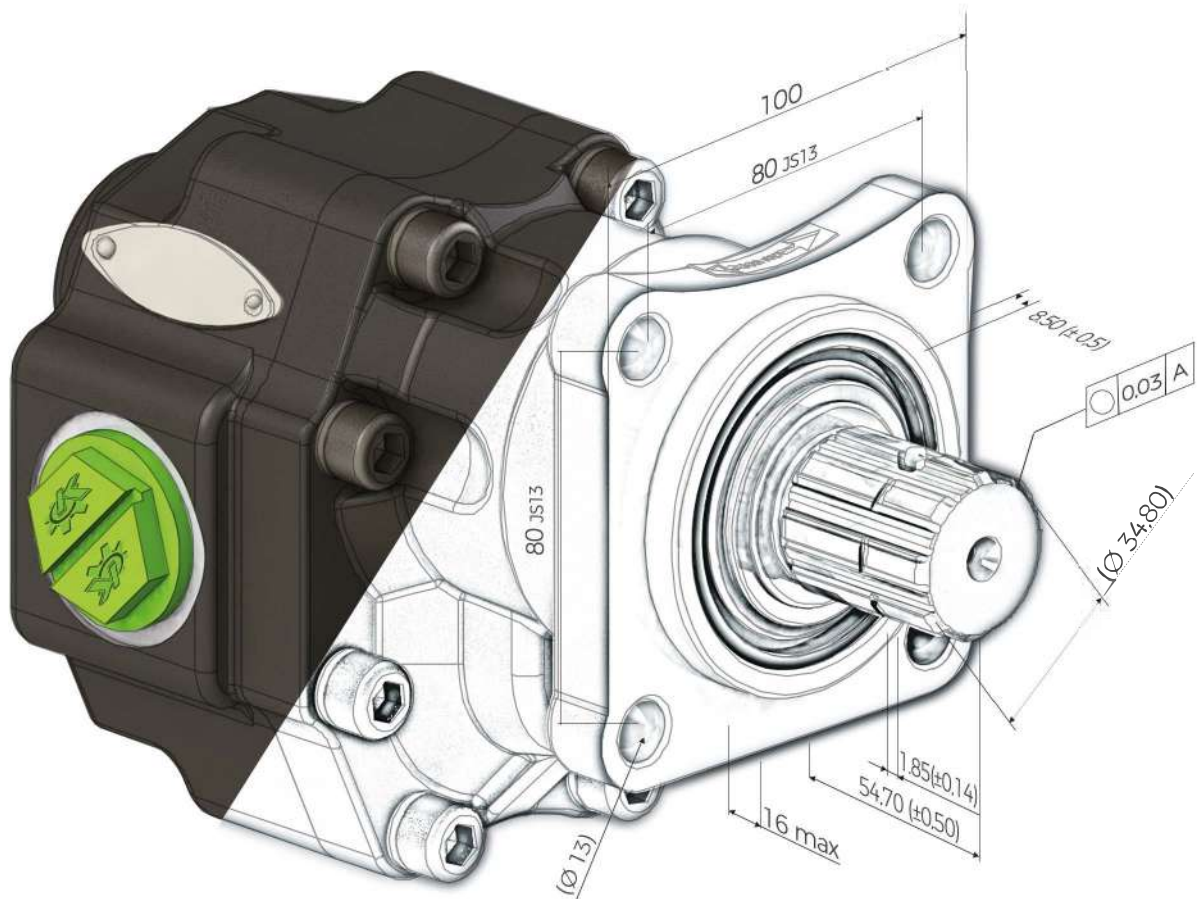

[www.kozmaksan.net](http://www.kozmaksan.net)



**PDCD**

**25**

**045**

**01**

**3**

**3**

Pompa Türü  
Pump Type

Pompa Tipi  
Pump Type

Pompa Debisi  
Displacement

Mil Tipi  
Shaft Type

Kapak Bağlantı Deliği  
Mounting Holes

Dönüş Yönü  
Rotation

## Pompanın Türü / Pump Type

- PDCD : Çift Dönüştü Dişli Pompa / **Bi Rotatonal Gear Pumps**  
PDTDK : K Serisi Dişli Pompa / **K Series Gear Pumps**  
PDTD : Tek Dönüştü Dişli Pompa / **Single Rotatonal Gear Pumps**  
PDTDT : Tandem Dişli Pompa / **Tandem Gear Pumps**  
PED : Pistonlu Pompa / **Piston Pumps**  
PEX7 : Eksenel Pompa / **Bent Axis Pump**

## Pompanın Tipi / Pump Type

- 25 : 25 Serisi Dişli Pompa / **25 Series Gear Pumps**  
30 : 30 Serisi Dişli Pompa / **30 Series Gear Pumps**  
35 : 35 Serisi Dişli Pompa / **35 Series Gear Pumps**  
40 : 40 Serisi Dişli Pompa / **40 Series Gear Pumps**  
09 : 9 Pistonlu Pompa / **9 Piston Pumps**  
06 : 6 Pistonlu Pompa / **6 Piston Pumps**  
52 : 7 Pistonlu Pompa / **7 Bent Axis Piston Pump**

## Pompanın Debisi / Displacement

- 015 - 025 - 035 - 045 : 15 - 25 - 35 - 45 litre / **15 - 25 - 35 - 45 liters**  
043 - 051 - 055 - 065 - 082 : 43 - 51 - 55 - 65 - 82 litre / **43 - 51 - 55 - 65 - 82 liters**  
075 - 085 - 090 - 105 - 125 : 75 - 85 - 90 - 105 - 125 litre / **75 - 85 - 90 - 105 - 125 liters**  
063 - 073 - 087 - 109 - 133 - 151 : 63 - 73 - 87 - 109 - 133 - 151 litre / **63 - 73 - 87 - 109 - 133 - 151 litres**  
050 - 060 - 080 : 50 - 60 - 80 litre / **50 - 60 - 80 litres**

## Mil / Shaft

- 00 : Milsiz / **Without Shaft**  
01 : 8 Frezeli Mil / **8 Traillet Shaft**  
02 : 6 Frezeli Mil / **6 Traillet Shaft**  
03 : Kama Düz / **Wedge Straight**  
04 : Kama Konik / **Tapered Wedge**

## Kapak Bağlantı Deliği / Mounting Holes

- : UNI  
3 : ISO  
5 : K Serisi / **K Series**

## Dönüş Yönü / Rotation

- : Sağ Dönüştü / **Clockwise (CW)**  
2 : Sol Dönüştü / **Anticlockwise (CCW)**  
3 : Çift Dönüştü / **Bi-Rotatonal**



# Pistonlu Pompa Piston Pumps



## Pompa Tipi Okuma Diyagramı | Type Reading Diagram

**PED** - **09** - **080** - **20** - **1** - **3** - **1**

Pistonlu Pompa  
Piston Pump

9 Pistonlu Pompa  
9 Piston Pump

Pompa Debisi  
Displacement

Mil Tipi  
Shaft Type  
DIN 5462 ISO

Bağlantı Tipi  
Mounting holes

Dönüş Yönü  
Rotation

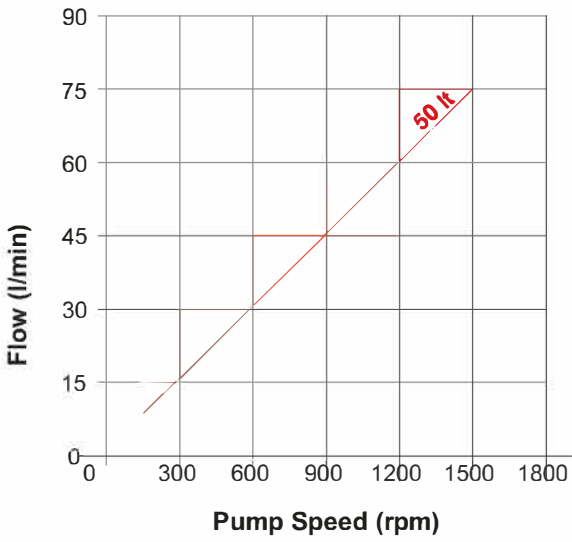

**50 LT**

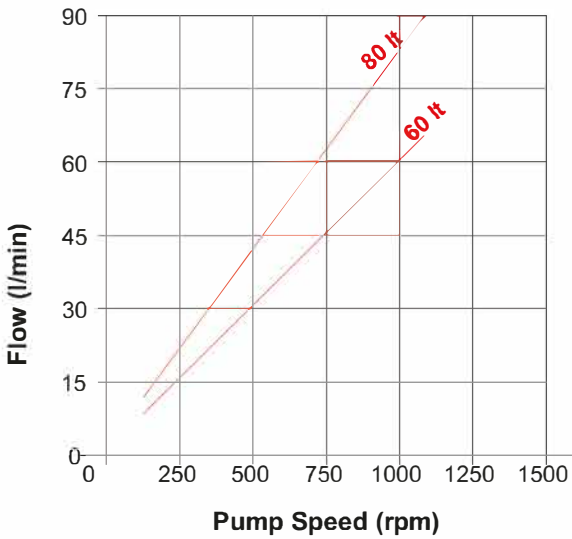
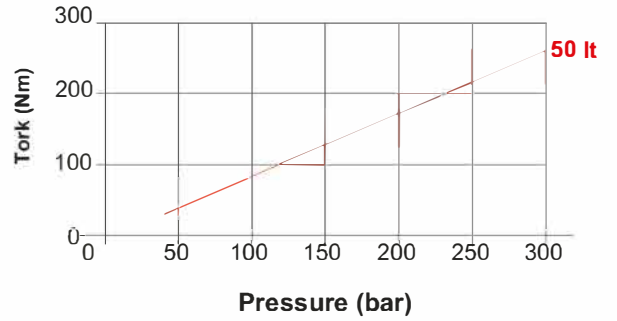

**60 - 80 LT**

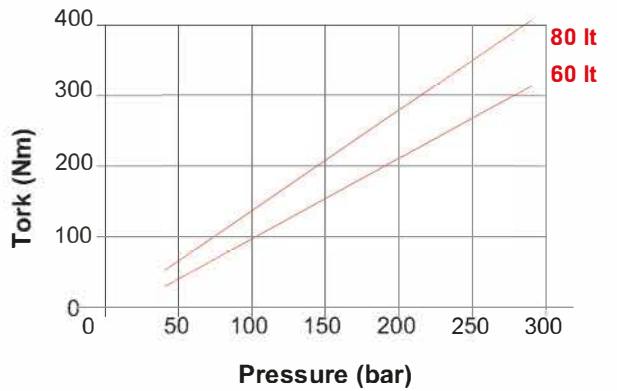

ürün kodu | product code  
PED0906020133

ürün kodu | product code  
PED0908020133

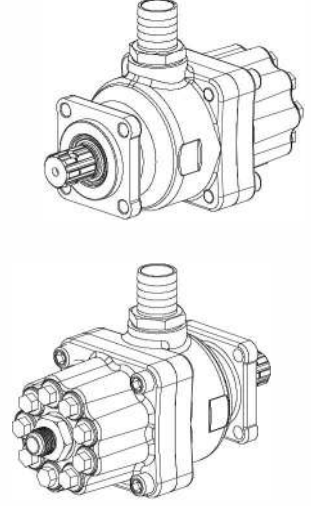
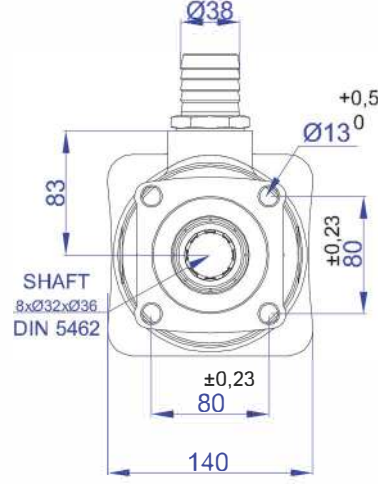
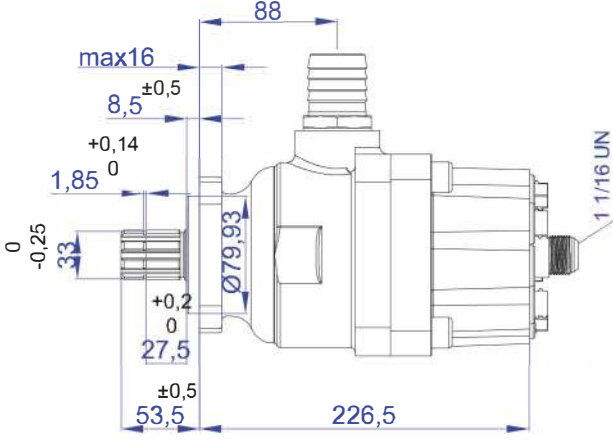

Pompa Tipi Pump Type	Debi Displacement	Max. Sürekli Hız Max. Speed at Continuous Press.	Maksimum Kesik Hız Max. Speed at Intermittent Press.(nmax)	Min Kesik Hız Min. Speed at Intermittent Press.	Max Sürekli Basınç Max. Continuous Pressure (Pnom)	Max. Kesik Basınç Max. Intermittent Pressure (Pmax)	Max. Pik Basınç Max. Peak Pressure (Pmax)
	lt/min	n (min <sup>-1</sup> ) (≤ P1)	n (min <sup>-1</sup> ) (P ≤ 30 bar)	n (min <sup>-1</sup> )	bar	bar	bar
60 lt	60	1500	2000	300	290	320	350
80 lt	80	1400	1800	300	280	310	330

ürün kodu | product code  
PED0605010133

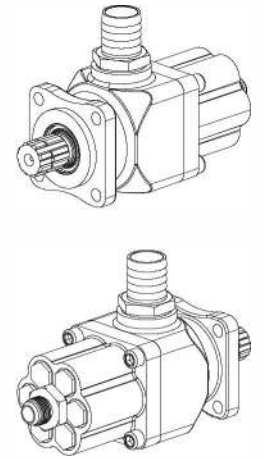
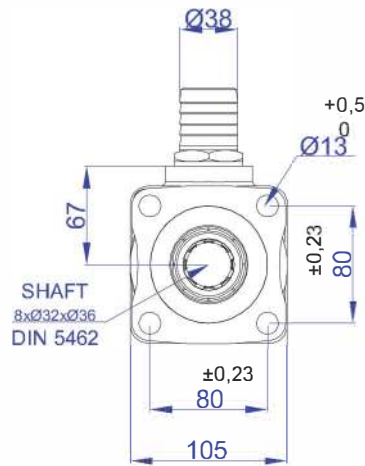
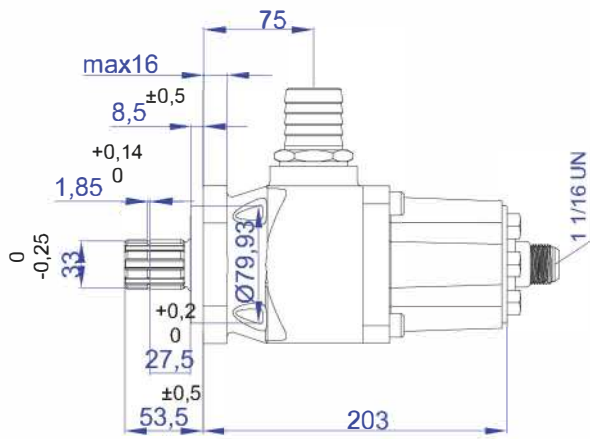

Pompa Tipi Pump Type	Debi Displacement	Max. Sürekli Hız Max. Speed at Continuous Press.	Maksimum Kesik Hız Max. Speed at Intermittent Press.(nmax)	Min Kesik Hız Min. Speed at Intermittent Press.	Max Sürekli Basınç Max. Continuous Pressure (Pnom)	Max. Kesik Basınç Max. Intermittent Pressure (Pmax)	Max. Pik Basınç Max. Peak Pressure (Pmax)
	lt/min	n (min <sup>-1</sup> ) (≤ P1)	n (min <sup>-1</sup> ) (P ≤ 30 bar)	n (min <sup>-1</sup> )	bar	bar	bar
50 lt	50	1600	2100	300	300	330	350